

# Pompie's Pillar

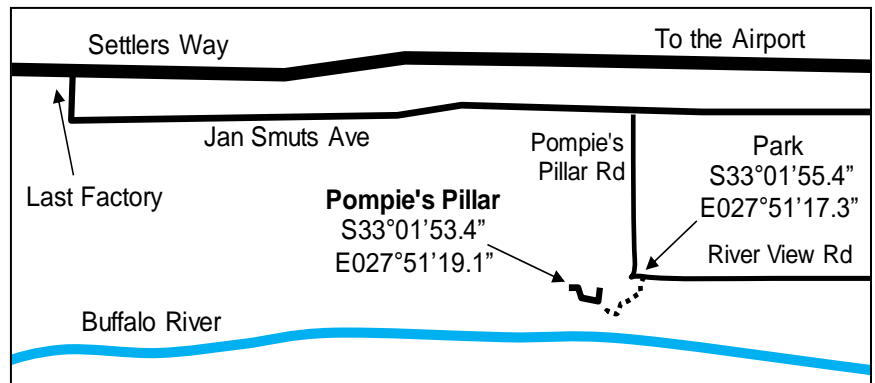

**Legal Note:** All climbing is very dangerous & always at your own risk. Nobody is forcing you to climb. You choose to climb, so choose to go home before the risks become too high. Remember even small injuries can take 6 weeks to heal. No responsibility for inaccurate or incomplete information will be accepted by the scribe. The landowner accepts no liability at all. Climbers take full responsibility for themselves at all times. Fixed protection will become unreliable, loose rock is common, solid rock becomes loose & RD writers make up most of the information, with a beer, at the computer. This RD is only a guide & is no substitute for experience, training, common sense & a touch of caution. So, you are on your own...take care!



**Note from the Scribe:** It took consistent effort, time, work & organization to get this guide ready for your pleasure...for free! Thus, please respect that all the information & photographs are strictly Copy Righted. You are more than welcome to print out, e-mail or link to a web page this guide in its unchanged format, with logos & all information intact.

As this is a web-based guide it can be considered a continual work in progress. It is easy to change. So please send missing details, corrections, additions & adjustments to [info@easterncaprockclimbing.co.za](mailto:info@easterncaprockclimbing.co.za). All information will be greatly appreciated.

**Directions:** From Oxford Street circle take Settlers Way toward the airport. Turn R after the last factory on the RH side, to gain the road running parallel to Settlers Way. Past the Fire Station. Turn R into Pompie's Pillar Road. At the point where Pompie's Road meets River View Road, park. Walk through the open plot to the sewage line. You can't miss the pillar. There is other rock in the area.

**Access:** Unrestricted. Don't walk through any private gardens.

**Walk-in:** 1 minute. 80m. Quite steep.

**Time & Weather:** Very sunny in summer. Wimps should try winter.

**Rock Type:** Clean hard dolerite set in thick bush.

**Potential:** Not much left near Pompie's Pillar, but further down river there is a fair amount of rock visible. Allen Luck has opened 6 lines there. Including on the prominent free stander. All of these were opened in secret behind his mate's backs... nice chap! One really crap line was opened about 300m down stream & below the sewage line, by Derek Marshall & Garvin Jacobs in 2000.

**History:** Situated on the Buffalo River this is one of the first crags to be climbed in East London. Neil Briers used to take school pupils top roping here, but never bothered to lead any of the lines. The bolted route was bolted with a generator and extension cords. Look out for East London's only Bushman painting, its probably fake.

**Star Ratings**

- ★★★ Classic route in this province
- ★★ Good route in the area
- ★ Good route at this crag
- No star Reasonable to bollocks

**Abbreviations & Symbols**

- 7<sub>19</sub> (T) Trad route (natural gear) & grade
- 9<sub>21</sub> ● Sport route (bolted) & grade
- 4<sub>-26</sub> ● Open Project / in-progress & ± grade
- 4<sub>-26</sub> ● Closed Project & ± grade
- 7<sub>19</sub> (S) FA was solo & grade
- ▲ Potential
- ↻ Abseil point
- (11B&C) Number of bolts & top chains
- P / RB Piton / Removable bolt
- Afternoon Shade
- Morning Shade
- Shade all day
- Sun all day
- Dappled shade all day
- Can be climbed in wet weather



**Hazards:** Beware of criminals! Carry a machete at all times...you may need it. Seriously! The sewage line is not always the sweetest thing.

**1. Facing the Fallacy – 14**

Start up the RH side of the nose, moving up & L to the top.

Derek Marshall & Heidi Smelders 14/01/2006 (T)

**2. Aim & Ablution – 17 ★**

Start up the LH side of the nose, moving up & L to the top.

Derek Marshall & Craig Bester 14/01/2006 (T)

**3. Iron Hand – 18 ★**

Crack system on the RH wall of the groove

Derek Marshall & Colin Hall Sept 1999 (T)

**4. Judge Dread – 17**

Groove to the R of the overhang.

Derek Marshall & Colin Hall Sept 1999 (T)

**5. Philippians 4:13 – 22 ★**

It's a bit contrived. Do not to step out R.

Derek Marshall & Garvin Jacobs Dec 1999 (6B&C)

**6. That Damn Dog – 17**

Crack system into an off width, just L of the overhang

Derek Marshall & Gavin Hall Sept 1999 (T)

**7. Hall of Fame – 16**

Crack system 1.5m L of the overhang.

Derek Marshall & Gavin Hall Sept 1999 (T)

**8. Gain & Gifting – 19 ★**

Same start as *Hall of Fame*. Traverse around the corner to the L into a finger crack. Up this onto a ledge. Then up the finger crack to the R.

Derek Marshall & William Lesley 14/01/2006 (T)

**9. Fame & Smashing – 16**

Up steps below curving hand crack. Move L up ledges to the top.

Derek Marshall & Ray Smith 14/01/2006 (T)

**10. Rompie Pompie – 16**

Up steps below large overhanging boulder. Move L into gully. Top out up the RH side of the gully.

Allen & Mark Luck 14/01/2006 (T)

**11. Pumping the Pump – 18**

Off width open book into gully. Under a block, rail R & up.

Allen Luck & Ray Smith 14/01/2006 (T)

**12. Jo! Jo! My Bitch! – 13**

L facing open book hand crack about 10m down river.

Craig Bester & William Lesley 14/01/2006 (T)

